

# Kit 1268

SCION xA, 5-dr Hatchback, \*04-07

TOYOTA Ist (Mk.I.), 5-dr Hatchback, 02-07

\*North America

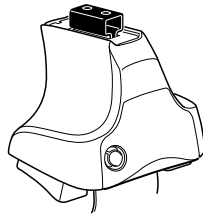

754 Rapid System  
480R Rapid Traverse (North America)

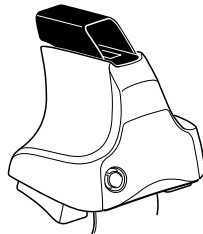
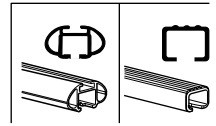

480 Traverse (North America)

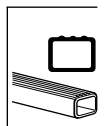



1

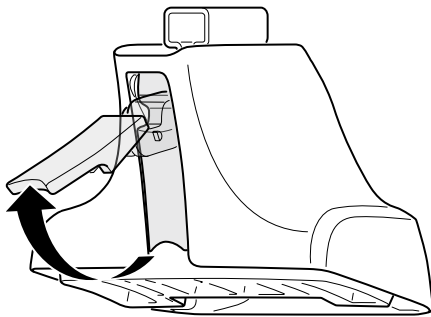

2



754 Rapid System  
480R Rapid Traverse  
(North America)

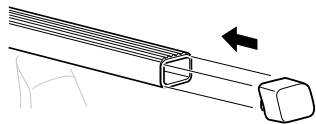
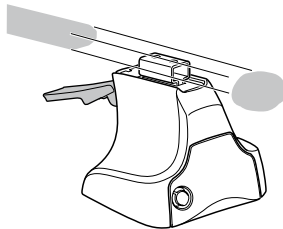

x4

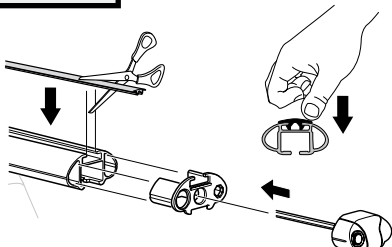
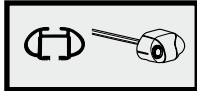

x4

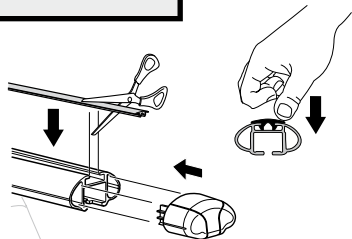
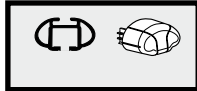

x4

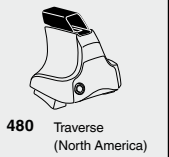

480 Traverse  
(North America)

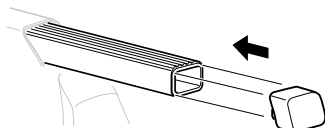
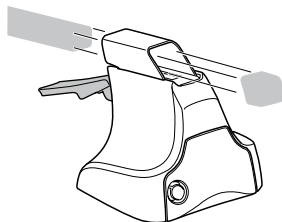

x4

**3**

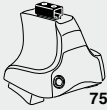

**754** Rapid System

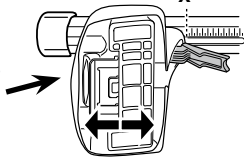

	X
<b>SCION xA</b> , 5-dr Hatchback, *04-07	<b>30,5</b>
<b>TOYOTA Ist (Mk.I)</b> , 5-dr Hatchback, 02-07	<b>30,5</b>

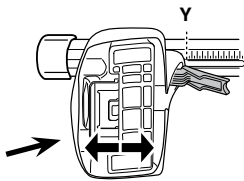

	Y
<b>SCION xA</b> , 5-dr Hatchback, *04-07	<b>28</b>
<b>TOYOTA Ist (Mk.I)</b> , 5-dr Hatchback, 02-07	<b>28</b>

**3**



**480R** Rapid Traverse



**480** Traverse

**(North America)**

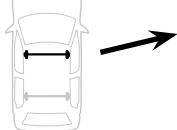

	X inch	X mm
<b>SCION xA</b> , 5-dr Hatchback, *04-07	<b>37 <sup>5</sup>/<sub>8</sub> "</b>	<b>956 mm</b>
<b>TOYOTA Ist (Mk.I)</b> , 5-dr Hatchback, 02-07	<b>37 <sup>5</sup>/<sub>8</sub> "</b>	<b>956 mm</b>

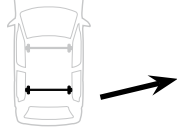

	Y inch	Y mm
<b>SCION xA</b> , 5-dr Hatchback, *04-07	<b>36 <sup>5</sup>/<sub>8</sub> "</b>	<b>931 mm</b>
<b>TOYOTA Ist (Mk.I)</b> , 5-dr Hatchback, 02-07	<b>36 <sup>5</sup>/<sub>8</sub> "</b>	<b>931 mm</b>

**4**

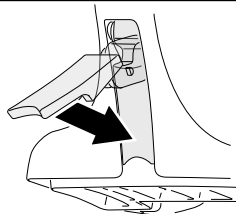

# 5

SCION xA, 5-dr Hatchback, \*04-07

TOYOTA Ist (Mk.I.), 5-dr Hatchback, 02-07

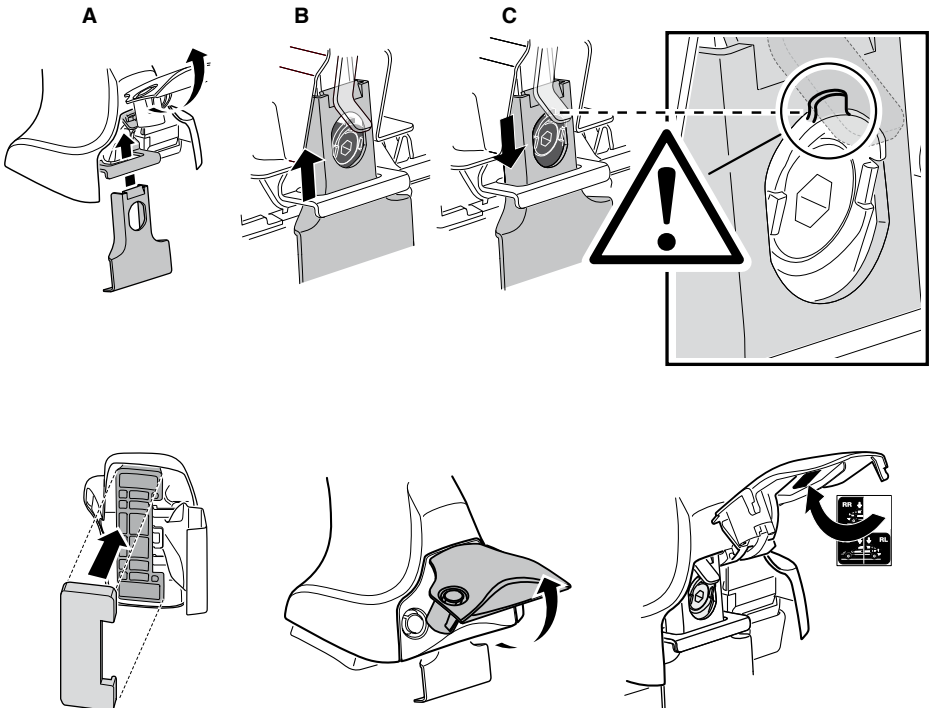
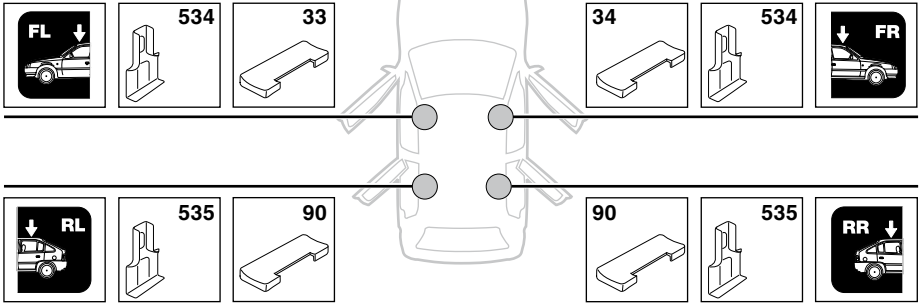

6

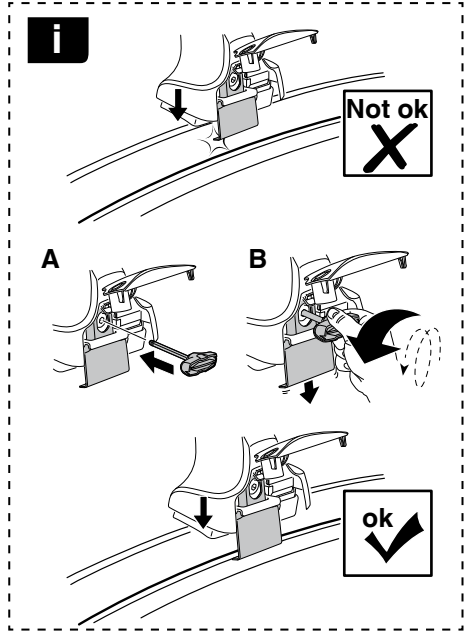
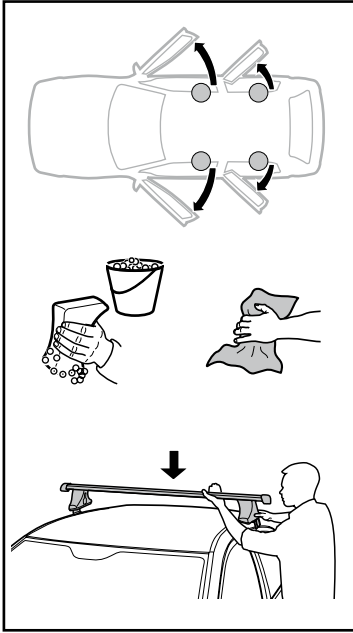

	X mm	Y mm	X inch	Y inch
SCION xA, 5-dr Hatchback, *04-07	195 mm	715 mm	7 5/8"	28 1/8"
TOYOTA Ist (Mk.I.), 5-dr Hatchback, 02-07	195 mm	715 mm	7 5/8"	28 1/8"

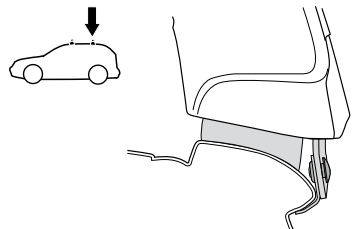
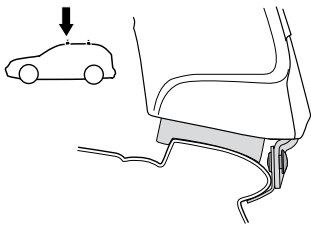
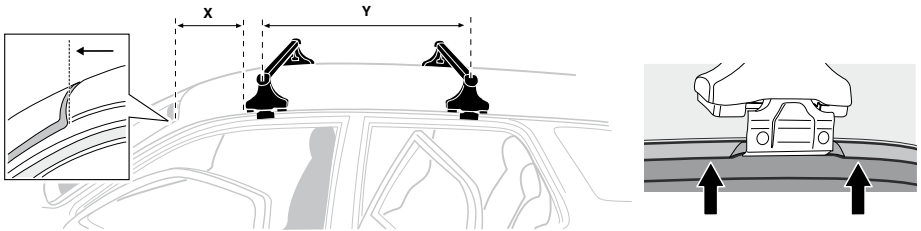

7

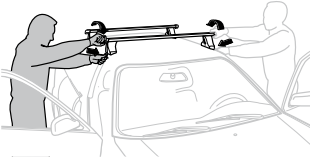

**GB/US** Tighten alternately  
**D** Die Schrauben abwechselnd anziehen  
**F** Serrer alternativement chaque côté  
**NL** Afwisselend aan de linker- en de rechterkant aandraaien  
**I** Alternare il serraggio delle viti  
**E** Apertar alternativamente  
**PT** Aperte alternadamente  
**S** Dra åt växelvis  
**FIN** Kierrä vuorotellen  
**EST** Pinguldage vaheldumisi  
**LAT** Pievelciēt pamišus  
**LIT** Užsukinėkite pakaitomis  
**PL** Śruby dokręcaj naprzemiennie  
**RU** Затягивайте попеременно

**CZ** Pokrétla bagażnika dokręcaj dokręcaj naprzemiennie.  
**SK** Doťahujte striedavo  
**SLO** Privijajte izmenično.  
**HR** Naizmjenično zategnite  
**HU** Egymástól függetlenül szorítandó  
**GR** Σφιγγεται εναλλάξ  
**TR** Dönüşümlü sıkın

**中文** 交替拧紧

**한국어** 번갈아 가며 조이십시오.

**日本語** 交互に締め付けてください。

**ไทย** ชั้้นในแบบสลับ

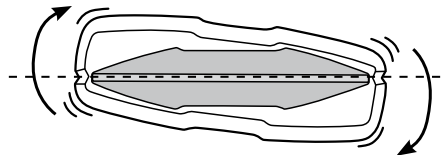
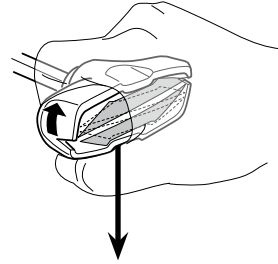
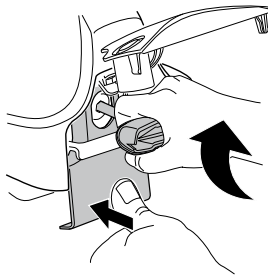
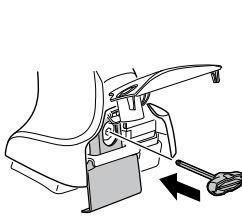

≈ 3 Nm

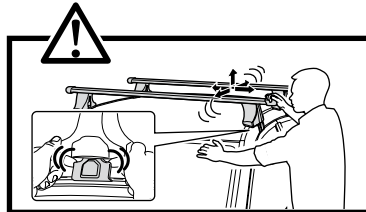
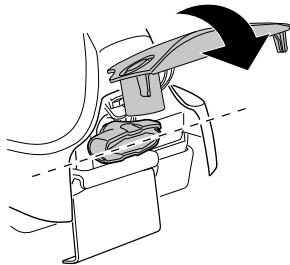

8



x1  
17 mm

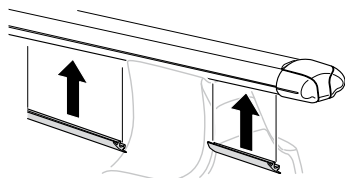

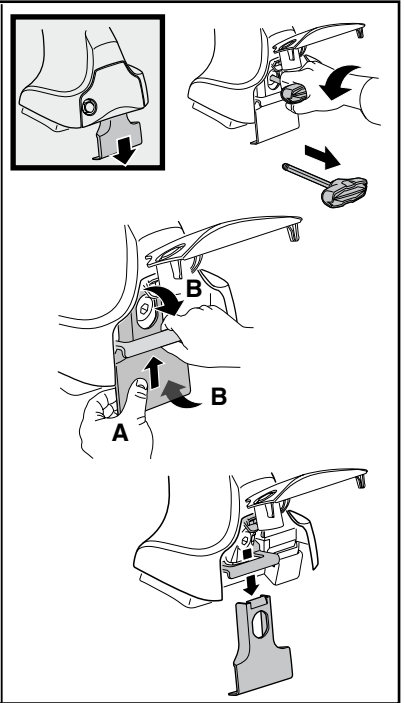
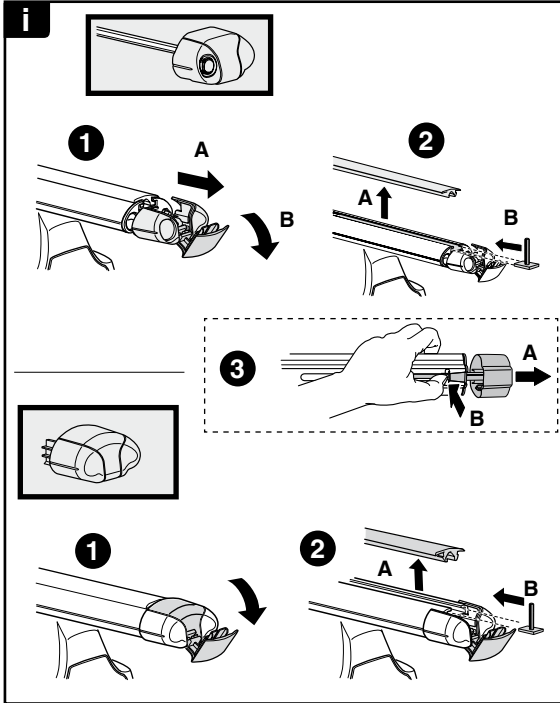
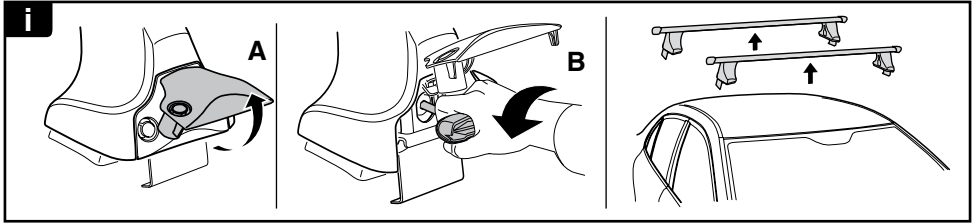

**THULE**  
SWEDEN  
**ONE  
KEY  
SYSTEM**

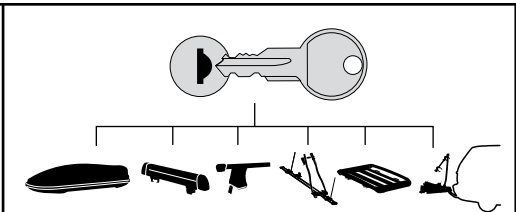

- 544** (x4)
  - 596** (x6)
  - 588** (x8)
  - 510** (x10)
  - 452** (x12)
- NA  
EUR  
ASIA

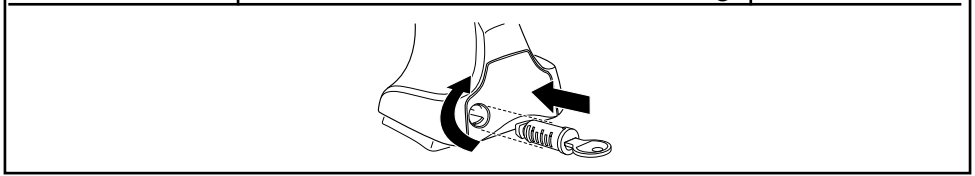

WW ▶ Thule Sweden AB, Box 69, 330 33 Hillerstorp, SWEDEN  
NA ▶ Thule Inc., 42 Silvermine Road, Seymour, Connecticut 06483, USA

info@thule.com  
customer.service@thule.com

www.thule.com